

## GM-TC Stainless Steel 316 Toggle Latch

### Features

- Over center cam action catch
- Accept padlock up to 6 mm shackle
- Uses screw size #8

### Material

- Stainless steel 316

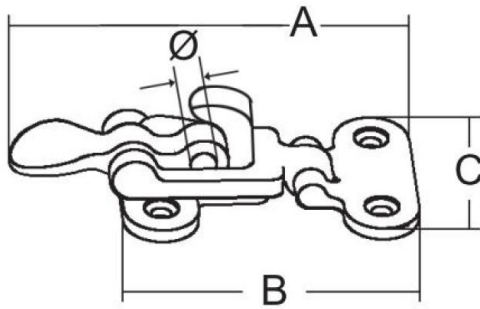

Part No.	A	B	C	Ø
GM-TC-I821203	100	75	46	6.5

## GM-HDC Stainless Steel 316 Hold Down Clamp

### Features

- Over center tension latch
- Thin cast for modern look
- Accept padlock up to 6 mm shackle
- Uses screw size #6

### Material

- Stainless steel 316



GM-HDC-I821204



GM-HDC-I821205

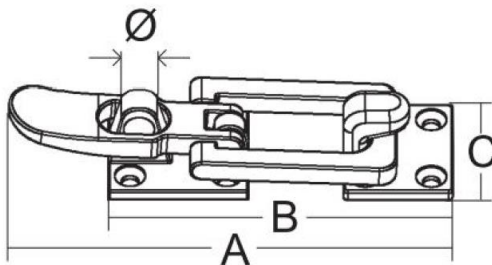

Part No.	A	B	C	Ø
GM-HDC-I821204	95	75	28	7
GM-HDC-I821205	89	70		